

| SCHÖNOX POOL LINE

| Perfectly coordinated
for perfect execution |



Photo: FilsFram AS



FOR PROFESSIONALS. SIMPLY BETTER.

| www.schonox.com |

 **SCHÖNOX**[®]
A SIKA BRAND

| Content |

- 2 – 3 Summary
- 4 – 5 Pool Edge Systems
- 6 – 7 Subfloor preparation depending on specified loading class of area
- 8 – 9 Waterproofing
- 10 – 11 Installing the Sealing System SCHÖNOX AB 10/30
- 12 – 13 Capillary breaking level
- 14 – 15 Installing tiles
- 16 – 17 Grouting
- 18 – 19 POOL LINE the full system at a glance

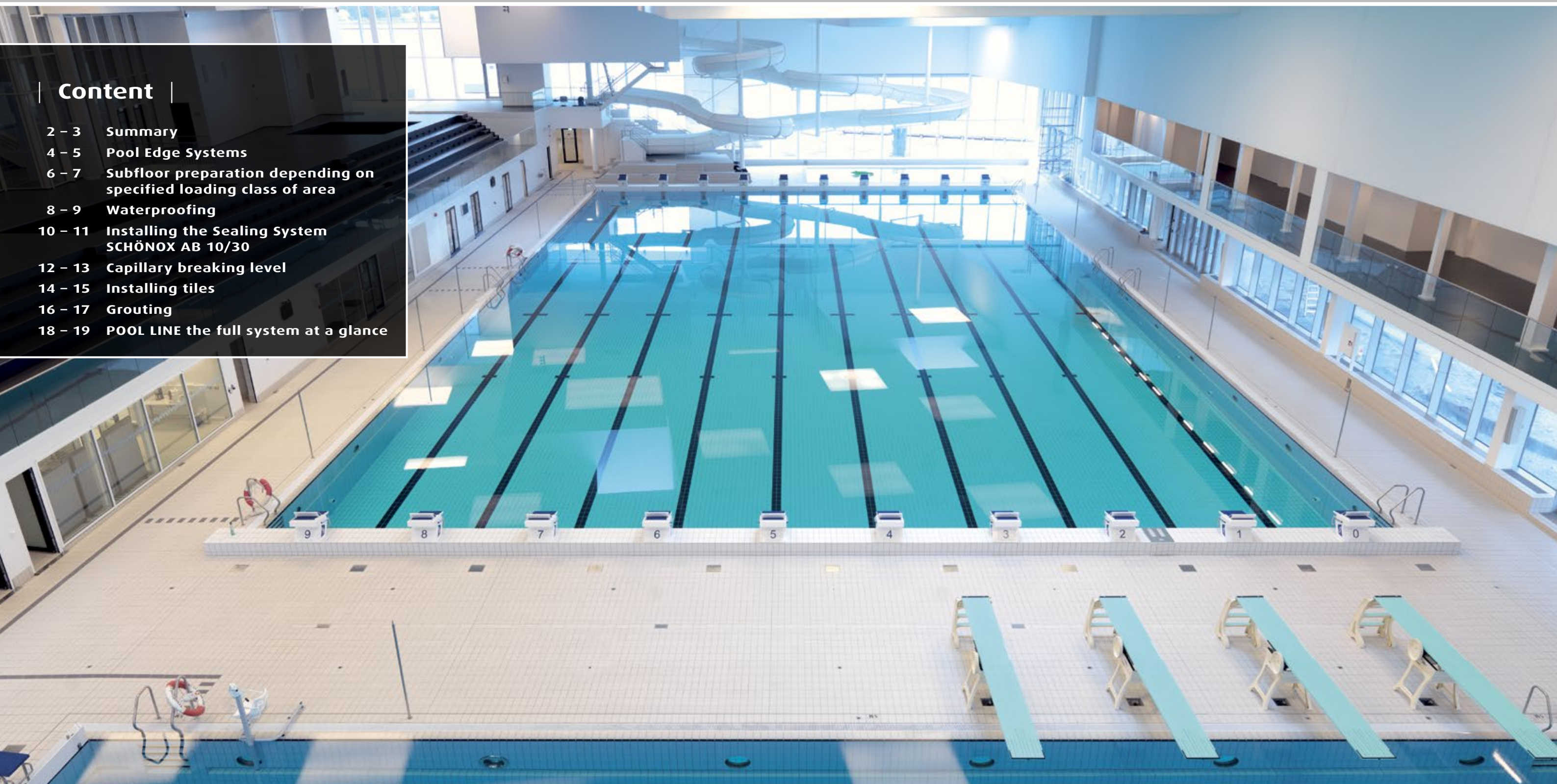

What makes a pool particularly attractive?

Shining tiles, a totally flawless appearance and perfect hygiene. That applies equally for both public and private pools. The mere sight of them is an invitation to plunge in, their use a sheer pleasure. Time and time again. Tiles undoubtedly create a better pool atmosphere and make it more attractive. Laying ceramic tiles in a pool also indis-

putably poses a particular challenge, especially in modern wellness centres with their mixture of different materials. In addition, pools are highly stressed structures on account of the water pressure and corrosive cleaning agents. With POOL LINE, SCHÖNOX can offer you a perfectly matched, high-quality product line that makes your work distinctly easier and ensures the long-term durability of your pool.

Every single product helps to ensure that the pool remains functional and attractive for a long, long time. All the photographs in this brochure show reference pools throughout Europe which were built with SCHÖNOX POOL LINE products.

| Key Elements of the Pool

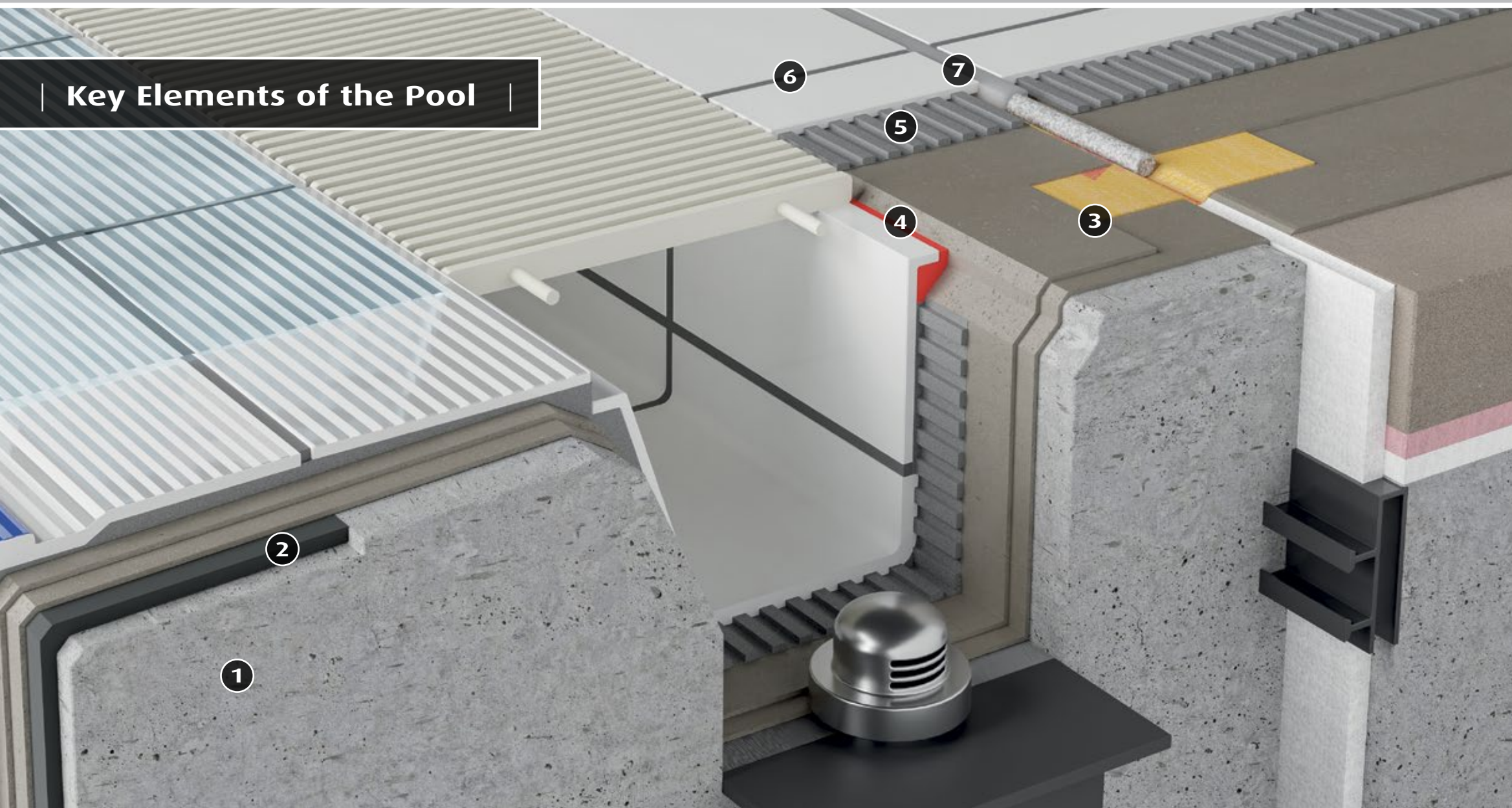

| System components

- ① Waterproof Concrete
- ② Wall Levelling: Sika MonoTop® 910 N and Sika MonoTop® 412 DE
- ③ Sealing Membrane: SCHÖNOX 2K DS RAPID + SCHÖNOX ST FUGENDICHTBAND
- ④ Sealing off capillaries: SCHÖNOX CON BODEN + QUARZSAND
- ⑤ Tile Adhesive: SCHÖNOX Q6
- ⑥ Grout Mortar: SCHÖNOX CF DESIGN
- ⑦ Joint Sealant : Sika® Rundschnur PE + SCHÖNOX MES



Pool Edge System Wiesbaden
deeper water level

Pool Edge System Finland
higher water level for a beach-like effect

Particular attention must be paid to the pool edge when planning a pool. Different constructions can be selected here. A distinction is made between high and low water levels, although pools with low water levels are rarely built today. The "Finnish" system and the "Wiesbaden" system with high water levels are probably the most commonly used systems today.

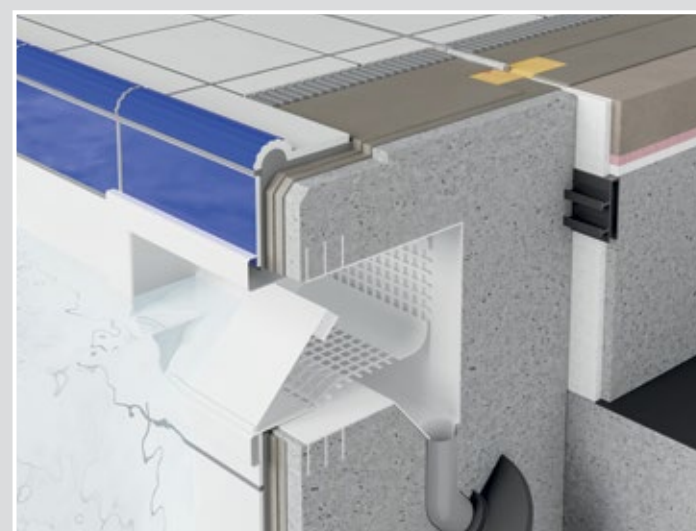

Pool Edge System Skimmer

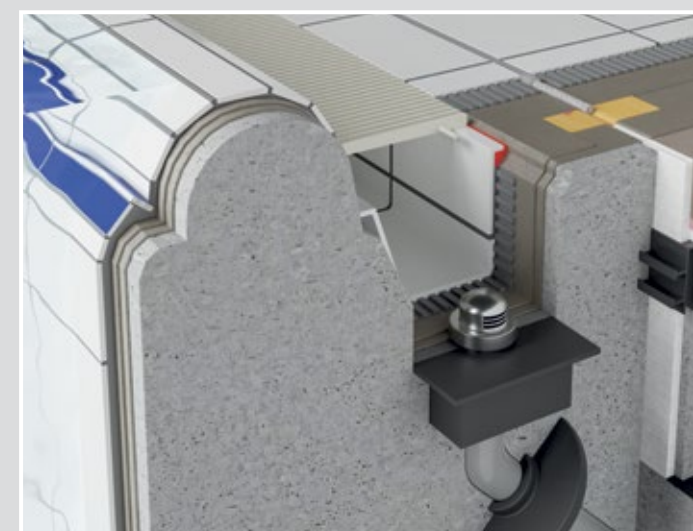

Pool Edge System St. Moritz



Pool Edge System Wiesbaden
higher water level

| Longstanding results
require planning with care |

Pool depth, the specific swimming pool areas as well as the type of the pool water used such as thermal, brine or seawater are to be considered as particularly highly loaded areas. Therefore, the planning requires a water analysis in order to be able to specify the suitable waterproofing system in accordance with DIN 4030 for water with aggressive lime.



Highly loaded areas without the presence of hydrostatic pressure
Pool surroundings, shower rooms, rest rooms, sauna.



Highly loaded areas with hydrostatic pressure
Private and commercial/public pools, interior & exterior.



Highly loaded areas including areas with chemical loading
Swimming pools and associated facilities in thermal baths, brine and sea water pools, steam showers.

Water loading classes for containers according to DIN 18535

Swimming pools with a depth of more than 5 m are regarded as highly loaded areas and are subject to water exposure class W2-B, over 10 m water depth to class W3-B.

Water loading class	Water depth
W1-B	≤ 5 m
W2-B	≤ 10 m
W3-B	> 10 m

Typically, chlorinated pool water is treated according to DIN 19643. Alternative disinfection methods such as using ozone support, are used in private areas with skimmers. The following loading classes are to be handled differently.

Subfloor preparation



The common type of concrete installed is concrete with high water penetration resistance, also known as water-impermeable concrete. A 14-day flood test of the new construction or alternatively after the water proofing system has dried, is essential prior to proceed. Other pool constructions, such as Glass fiber plastic basins (GFK) are to be specified on a case-by-case basis.



To identify the precise nature and specifics of the substrate and its load-bearing capacity is mandatory! Where necessary, a suitable subfloor preparation process including mechanical treatment such as water jet, air or sand blasting is essential to achieve a surface free of any bond breaking agents. Cracks of a widths > 0.2 mm are to be repaired with suitable systems such as injection materials and are to be coordinated with the specifier.



How to install a surface free of bond breakers

Wall and Floor Preparation

Prior to levelling the Pool Walls we recommend applying a bond coat using the premium Thin set SCHÖNOX Q6 installing suitable calibration scales. After drying of the bond coat, level the wall using SCHÖNOX BM 10 at an average thickness of approx. 10 mm. Remove the calibration scales and fill the remaining joints prior to installing the membrane system.

Alternatively the PCC mortar system Sika MonoTop® 910 N as bond coat and Sika MonoTop® 412 DE as Levelling Mortar may be used. The system is installed manually or using the wet spray technique. If a bonding screed is required to be respectively specified, SCHÖNOX SEB PLUS may be used to significantly shorten the renovation schedule. Where required, install a thin finish coat using the self-levelling underlayment SCHÖNOX FPL PLUS.

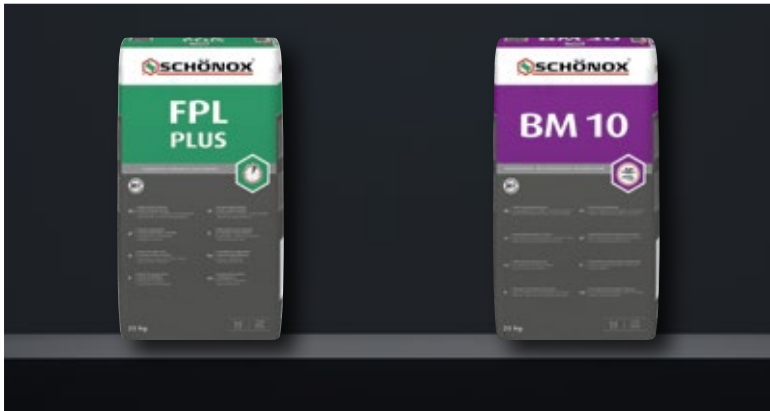

Installation of SCHÖNOX systems in private areas



LITERATURE TIP

Technical instruction
"Guidelines for the
design and installation
of swimming pools with
ceramic coverings"

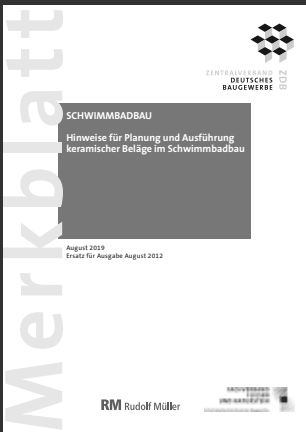

Waterproofing using powder-based bonding slurries

A crack-bridging waterproofing may be done installing the elastic bonding slurry SCHÖNOX 1K DS PREMIUM, which is a two coat system. For best results, the use in conjunction with suitable built-in components parts is required. Basic specifications for those components are ‘made of stainless steel, gunmetal or Vinyl. The flange ‘contact area’ must

be at least 5 cm in order to securely connect the composite tile seal. Other flanges are either to be widened up with adapter pieces or a suitable, capillary-breaking epoxy resin to protect the built-in component all around from a following moisture migration.



Sample repairs when insufficient flange contact area



Application of SCHÖNOX 1K DS PREMIUM



Installing SCHÖNOX 1K DS PREMIUM on moist concrete



Suitable assemblies:
www.aptgmbh.com



1 or 2 component, flexible membranes for bonded water proofing

2-component epoxy & polyurethane-based waterproofing system



Apply the epoxy based system component primer SCHÖNOX GEA using a suitable, short piled roller following the product data sheet.



After drying, sand broadcast in excess.



When the epoxy has dried accordingly, broom sweep and vacuum the surface removing any loose sand.



Apply the polyurethane based membrane SCHÖNOX EA PUR / EA PUR S using a 6 mm trowel.



Within 12 - 24 hrs apply the coloured coat of SCHÖNOX EA PUR using a suitable roller.



Sand broadcast & cleaning steps again following the product data sheet.

Installing SCHÖNOX AB 10/30 using SCHÖNOX iFIX®

The sheet membrane SCHÖNOX AB 10/30 is installed using the rollable sealing adhesive SCHÖNOX iFIX® and is the pre-ferrable system solution for the highest loading classes.

After mixing the SCHÖNOX iFIX® components, SCHÖNOX iFIX is applied using the system roller to insert the ‘cut to shape’ sheet membrane SCHÖNOX AB 10/30 into the fresh adhesive ensuring a sufficient wetting.

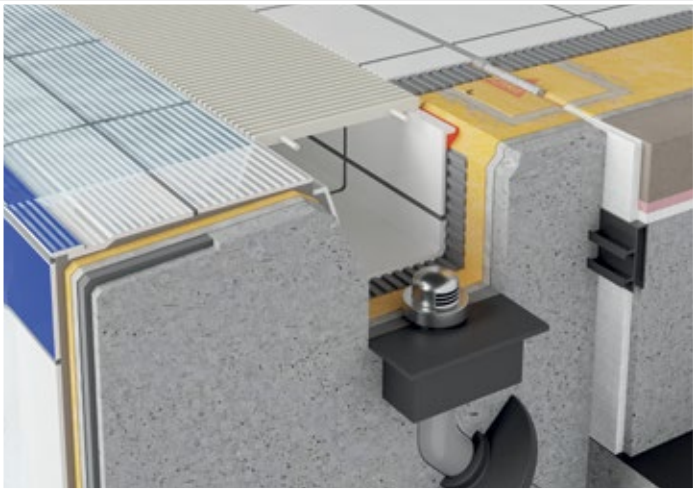

Installing SCHÖNOX AB 10/30 using SCHÖNOX iFIX® and the SCHÖNOX Toolbox containing all required tools.

Install the sheet membrane within the open time of approx. 15 minutes to achieve the suitable bond. Joints are to be sealed using the SCHÖNOX ST50 Sealing Tape glued with SCHÖNOX iFIX®. Alternatively overlap SCHÖNOX AB sealing the overlaps using SCHÖNOX iFIX® as well. If installed in brine pools, the waterproofing system are installed using SCHÖNOX EA PUR S instead of SCHÖNOX iFIX®.



Pressing on SCHÖNOX AB 10/30 around suitable edges.

Case study:
Renovation of a
therapy pool

Renovation of a therapy pool with overflow unit type ‘St. Moritz’ and custom made stainless steel gutter.

Pool surroudings are water proofed using the SCHÖNOX iFIX® system and the joint martar SCHÖNOX CON BODEN aggregated with SCHÖNOX QUARZ-SAND 0.2 - 0.8 mm. The surface iss and broadcasted with a coarser aggregate, grain size 0.7 - 1.2 mm in conformance with the relevant German standards (minimum joint width and depth of 15 by 50 mm).

| SCHÖNOX AB-system

The waterproofing properties of the installed system SCHÖNOX AB 10/30 bonded with SCHÖNOX iFIX® sealing adhesive and using the additional system components are approved according to the German standards up to 2.5 bar water pressure and 10 m pool depth.

Application in pools up to 10 m depth.



Technical Data	
Color:	yellow
Sheet width:	1.00 m
Roll length:	10.0 m and 30.0 m
Material thickness:	appr. 0.5 mm
Mass per unit area:	approx. 280 g/m²
Application temperature:	not below +5 °C
Temperature resistance:	-30 °C to +90 °C
Burst pressure:	≥ 3.9 bar
sd-value:	> 96 m tested according ETAG 022
UV-resistance:	≥ 500 hours



Picture lower right: Installing of SCHÖNOX AB in under water area.

The necessity of sealing the capillaries

The capillary sealing system based on epoxy is essential when installing/renovating high level overflow units! Pool water intends to level up with the pool surrounding, which is called ‘communicating tubes’. So as a consequence of not sealing properly, the water will be most definitely penetrating downwards to the lower rooms or to the surroundings.



The consequence of insufficient capillary sealing.

The minimum requirement following for filling ‘joint chamber’ properly, as specified following the German ZDB standard, is 15mm width by 50mm depth. The epoxi based sealing/filling is done with SCHÖNOX CON BODEN aggregated with SCHÖNOX QUARZSAND 0.2 - 0.8 mm, which then is broadcasted with the same aggregate after application.



‘Communicating tubes’ without the sealing of the capillaries and water proofing tapes resulting in failures from penetrating moisture to the pool surroundings and/or the lower rooms.

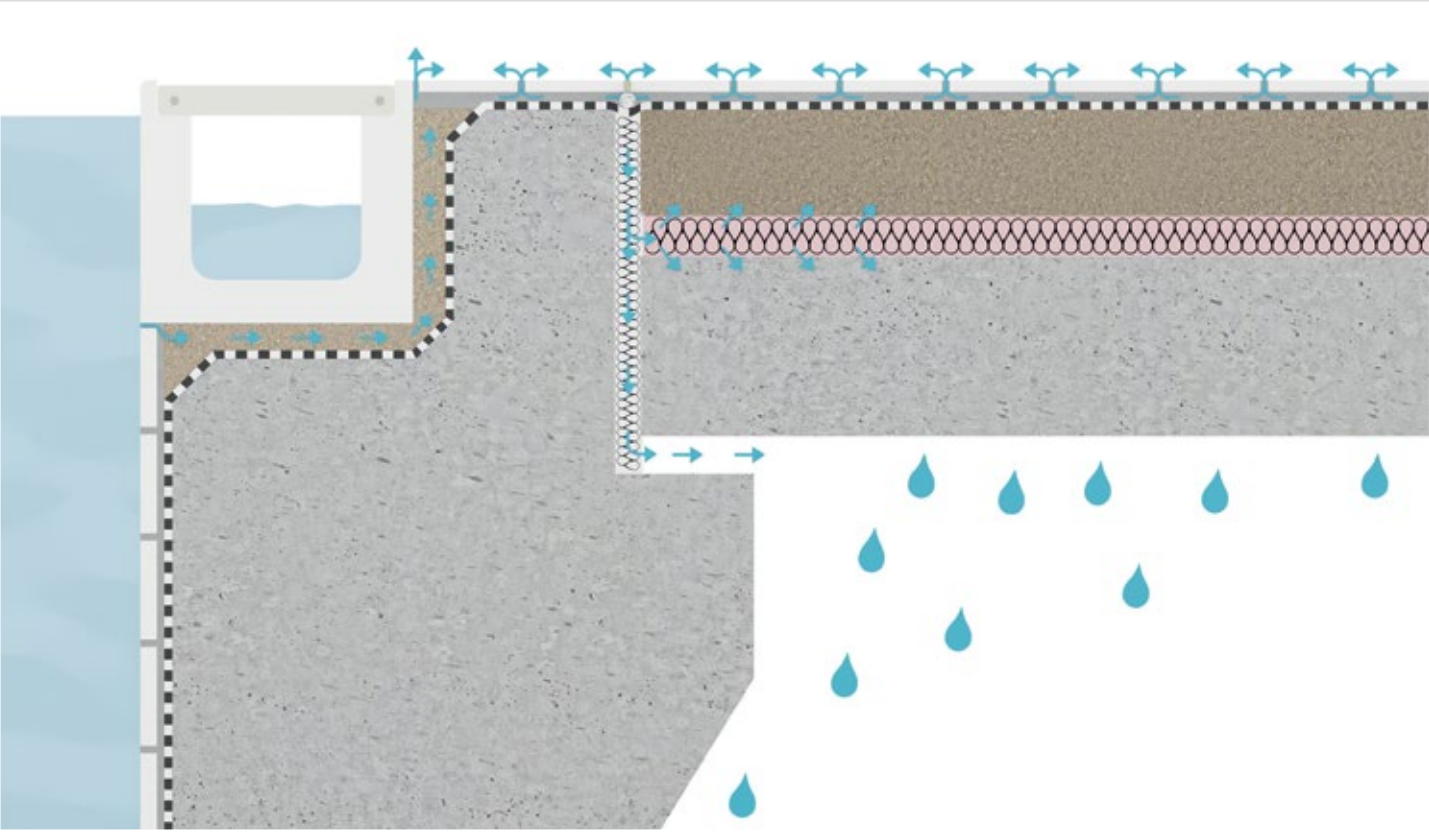

The consequence of not sealing capillaries.

| How to install a ‘capillary breaking’ mortar system based on epoxy. |

Depending on type (grain size and amount) of the used aggregate, SCHÖNOX CON BODEN can be used with the required consistency – sturdy or flowable.



To maximise a suitable bond, the backing of the single components/form parts is primed with neat SCHÖNOX CON BODEN prior to embed into the aggregated mortar.



Detail picture of an embedded form part into the aggregated mortar



Installing the capillary breaking joint mortar section by section using prepared templates.

Sealing the offset of molded pool parts is an important part of the process, ideally performed with trass cement mortar. Alternatively, avoiding the risk of efflorescence and increasing the physical bond at the same time, the use of water-free, epoxy-based mortar, a mix of 1 part epoxy resin and 10 parts of aggregate such as SCHÖNOX QUARZSAND 0.1-3.0 mm, may be used. Ideally, SCHÖNOX CON BODEN is being used for this application after aggregating the resin with SCHÖNOX QUARZSAND aggregate 0.2-0.8 mm.



Primer and Mortar system component based on epoxy

| Installing tiles

Since a variety of tile coverings (mosaic, natural stone, LFT) and mortar systems are available, installations in under water areas require specific approvals from the manufacturers. Not only the approval of all involved manufacturers is mandatory, but also the following installation of the full system is to follow all relevant guidelines and standards (floating buttering according to DIN EN 18157) avoiding voids as far as possible.

Depending on substrate and type of end-used pool water, cement-based, epoxy resin or polyurethane-based tile

adhesive are to be used. A water analysis (thermal and brine pools!) from the specifier or end user, are mandatory to be able to determine whether cement-based or epoxy resin-based systems are to be specified. The rules and regulations in regard to the covering manufacturers are to be followed installing 'void-free' and avoiding growths of microorganisms below the coverings, as well as other important topics such as slip resistance and general rules of swimming pool technology such as pool commissioning, maintenance, emptying process etc..



Installing following the floating buttering method resulting in a 'void-free' installation. Picture left: Approving a suitable wetting.



Movement joints are filled with suitable, permanently elastic joint fillers according to the ZDB leaflet "Movement joints in cladding and coverings made of tiles and slabs".



Glass mosaic mats for under water end are typically fixed together topically and must always be installed following manufacturer guidelines!

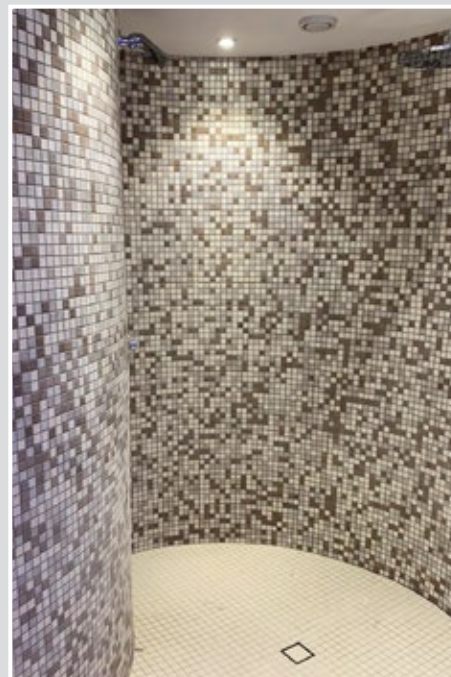

| The best tile adhesives to face your challenge |

Installation of tiles in areas not exposed to the elements.



Foto: FlisFram AS



SCHÖNOX System Solutions approved in multiple projects around the globe.

| **Tile Grouting – Best possible resistance including a brilliant visual appearance** |



Joints are substantial and indispensable to relax movement and avoiding cracks. Top surface, colour and resistance of an installed joint mortar are essential to finish the installation of premium, hygienic ceramic tile coverings.



Use the professional board holder to spread the material deep into the joints.



Use hydro sponge to emulsify any residual material.



Wash the joints smooth and clean with a hydro sponge board.

Please follow the QR-Code to get to the application video of SCHÖNOX CF DESIGN



The ideal Joint Mortar solution for any type of tile and mosaic



SCHÖNOX CF DESIGN is suitable as adhesive as well as joint mortar for any suitable glass mosaic tiling.

To ensure the system can withstand the typical moving and cleaning loadings of swimming pools, we recommend using premium products (such as grout mortar following DIN EN 13888 CG) only! Premium cementitious or epoxi based systems are suitable for these loading classes..

To install glass mosaic, we recommend using epoxy-based tile adhesive as well as grout mortar.

The system is completed following a cleaning concept as specified by Witty, our recommended supplier of cleaning systems.



PRACTICE TIP

For professional application use SCHÖNOX EPOXY TOOL-BOX. It includes ideal tools for grouting epoxy tile joints.



The best possible joint system solution for any type of loading.



Product category	Product name	Underwater area	Pool surrounding / shower area	Steam shower / liquid membranes or membrane applies construction board	Brine, thermal or sea water pool	Glass fiber polymer pool (GfK)
Levelling Compounds / Screeds	SCHÖNOX® PL Universal repairing mortar					
	SCHÖNOX® PL PLUS Ready mixed repair mortar for use from 3 – 30 mm					
	SCHÖNOX® BM 10 Highly dust reduced, fine levelling concrete mortar					
	SCHÖNOX® FPL PLUS Self-levelling compound for use from 3 – 60 mm					
	Sika MonoTop® 910 N Polymer modified, 1-component cementitious bonding primer					
	Sika MonoTop® 412 DE 1-component, fibre reinforced and low shrinkage repair mortar and waterproofing					
	Sikadur®-31 CF Rapid 2-component thixotropic epoxy-based adhesive					
Membranes	SCHÖNOX® 1K DS PREMIUM Rapid setting, flexible waterproofing membrane					
	SCHÖNOX® 2K DS RAPID Rapid setting, flexible 2-component cementitious membrane					
	SCHÖNOX® EA PUR / EA PUR S 2-component polyurethane waterproofing					
	SCHÖNOX® AB 30 / AB 10 Sealing and uncoupling layer					
	SCHÖNOX® iFIX® 2-component rollable waterproof adhesive					
	SCHÖNOX® ST Systemkomponenten Sealing sleeves and tapes					
Capillary Sealing	SCHÖNOX® CON BODEN + QUARZSAND Epoxy resin concentrate + Aggregate					
Tile Adhesives	SCHÖNOX® Q4 RAPID Highly dust reduced, rapid setting, flexible adhesive for wide range of applications					
	SCHÖNOX® Q6 Highly dust reduced, flexible universal powder adhesive					
	SCHÖNOX® Q6 W White, highly dust reduced, flexible universal powder adhesive					
	SCHÖNOX® Q12 Highly dust reduced, extremely flexible special powder adhesive					
	SCHÖNOX® KR Epoxy-based 2-component tile adhesive					
	SCHÖNOX® CF DESIGN Epoxy-based tile grout and adhesive for glass mosaics and tiles					
	SCHÖNOX® 2K PU SOLID White, 2-component polyurethane tile adhesive					
Grouting Compounds	SCHÖNOX® XR 40 Cementitious grouting mortar for hard wearing					
	SCHÖNOX® CF DESIGN Epoxy tile grout and adhesive for glass mosaics and tiles					
Sealing Compounds	Sika® Rundschnur PE Polyethylene Foam Backer Rod for filling cracks					
	SCHÖNOX® MES Natural stone silicone					

Precise details on use and processing can be found in the applicable product data sheets at www.schoenox.com.

preferred use possible use

Recommendations for cleaning:

As agreed with our partner Witty (supplier of cleaning agents), find our mutual cleaning recommendation attached:

- Rinse filter regularly
- Empty pool once per year for cleaning; drain and refill the pool slowly and uniformly
- Clean pool bottoms twice per week
- Clean pool sides every two weeks
- Clean overflows every week



www.witty.eu



| SCHÖNOX POOL LINE – system components |

Levelling Compounds / Screeds:

- SCHÖNOX® PL / PL PLUS
- SCHÖNOX® BM 10
- SCHÖNOX® FPL PLUS
- Sika MonoTop® 910 N
- Sika MonoTop® 412 DE
- Sikadur®-31 CF Rapid

Membranes:

- SCHÖNOX® 1K DS PREMIUM
- SCHÖNOX® 2K DS RAPID
- SCHÖNOX® EA PUR / EA PUR S
- SCHÖNOX® AB / iFIX®
- SCHÖNOX® ST Systemkomponenten

Capillary Breaking Level:

- SCHÖNOX® CON BODEN +
- SCHÖNOX® QUARZSAND (0.2 – 0.8 mm)
- SCHÖNOX® QUARZSAND (0.1 – 3.0 mm)

Tile Adhesives:

- SCHÖNOX® Q4 RAPID
- SCHÖNOX® Q6 / Q6 W
- SCHÖNOX® Q12
- SCHÖNOX® KR
- SCHÖNOX® CF DESIGN
- SCHÖNOX® 2K PU SOLID

Grouting and Sealing Compounds:

- SCHÖNOX® XR 40
- SCHÖNOX® CF DESIGN
- Sika® Rundschnur PE
- SCHÖNOX® MES



Photo: FlisFram AS

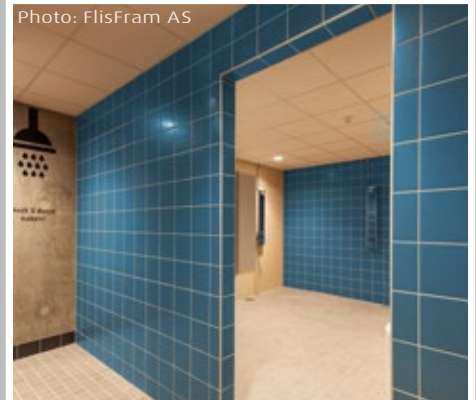

Sika Deutschland GmbH

Subsidiary Rosendahl
Alfred-Nobel-Straße 6
48720 Rosendahl, Germany
Tel.: +49 (0)2547-910-0
E-Mail: info@schoenox.de